

# PREDATOR 72

**STYLE:** PERFORMANCE MOTORYACHT

**ACCOMMODATION:** UP TO 6 GUESTS AND 2 CREW MEMBERS

**PERFORMANCE:** UP TO 38 KNOTS

OCCUPYING MIDDLE GROUND BETWEEN CREWED OR OWNER-DRIVER OPERATION, THE PREDATOR 72 PROVIDES FOR EITHER CHOICE WITH THE OPTION OF GARAGE OR CREW QUARTERS AFT. THE PRIORITY MIGHT BE OF COURSE TO SHELTER THE TENDER AND LEAVE THE BATHING PLATFORM FREE. THE MAIN DECK SHARES THE FLAIR FAMILIAR ON ALL PREDATORS, WIDE OPENING SALOON REAR DOORS CO-JOINING THE OPEN AFT COCKPIT AND INNER SALOON AND FURTHER BRINGING THE OUTDOORS INDOORS AT WILL WITH A HARD TOP THAT OPENS AT THE FLICK OF A SWITCH, LETTING LIGHT AND AIR POUR IN. AGAIN, BELOW THERE IS A RANGE OF OPTIONS IN CABIN PLAN TO MATCH INDIVIDUAL PREFERENCES.



Main deck

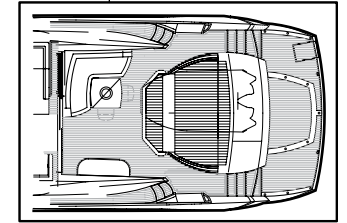
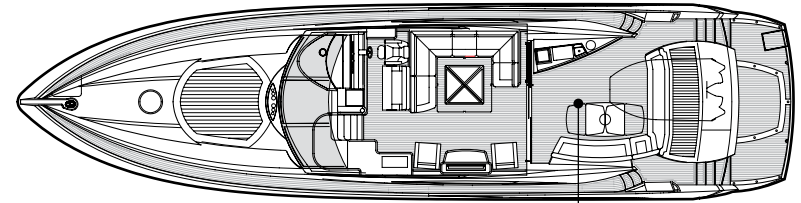

Optional extended galley bar

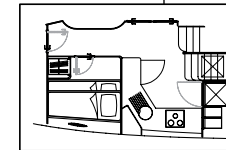
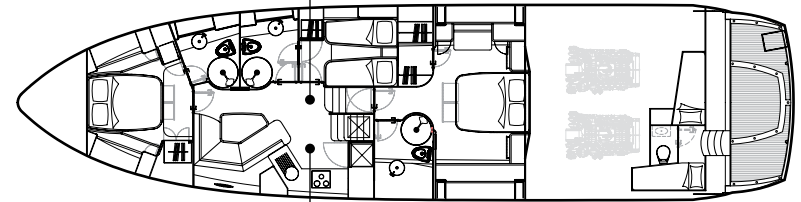
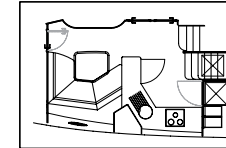

Optional port Pullman cabin

## PRINCIPAL CHARACTERISTICS

<b>Length overall – (incl. pulpit)</b>	22.26m	73'0"
<b>Length hull – (incl. platform)</b>	21.40m	70'3"
<b>Length waterline – (@ half load)</b>	16.50m	54'2"
<b>Beam – (maximum incl. rubbing strake)</b>	5.40m	17'9"
<b>Draft – (maximum @ full load)</b>	1.65m	5'5"
<b>Displacement – (@ half load)</b>	32500kg	106627lb
<b>Fuel capacity</b>	3900 litres	858 GB gal. 1030 US gal.
<b>Fresh-water capacity</b>	720 litres	158 GB gal. 190 US gal.
<b>Propulsion</b>	Twin FP props in tunnels	
<b>Engine options</b>	up to 3144 PS (total)	

<b>Fuel options</b>	Diesel
<b>Generators</b>	Standard 20kW @ 50Hz (Euro) 23kW @ 60Hz (US)
<b>Maximum speed</b>	up to 38 knots*
<b>Cruising speed</b>	up to 25 knots*
<b>Range</b>	up to 380 nautical miles*

All principal characteristics and specifications are provisional.



# PREDATOR 72

## PRINCIPAL FEATURES

Hydraulic lifting platform  
Garage under sunlounger  
Electric winch with deck and cockpit controls  
2 x stern electric capstan winches  
Hot and cold swim shower  
Wetbar with griddle, ice maker, ice chest, hot and cold water  
Radar and autopilot  
Power-assisted steering  
Electronic speedlog, depth sounder and VHF radio  
Trim tabs  
Flatscreen television and DVD/CD surround system in deck salon  
Radio/CD player  
Ceramic hob, microwave/grill, refrigerator and freezer  
Hot and cold water system  
Automatic fire extinguisher  
Automatic bilge pumps  
Slow speed generator with underwater silent exhaust  
AC shorepower/battery charger  
Vacuum toilets with holding tank  
Fresh-water marina connection  
Teak bathing platform and steps  
Teak cockpit  
Opening hardtop  
Air-conditioning  
Bow thruster  
Antifouling

All items included in standard specification.

US specification includes:  
US Coast Guard build regulations  
US specification appliances

## STANDARD SPECIFICATIONS

### 1 Construction

Hand-laid GRP  
Gel coat including stripes  
Vinylester skin coat with powderbound mat  
Stitched multi-axial reinforced single skin bottom  
Balsa cored hull topsides  
PVC foam cored deck and superstructure  
Hull stiffened with longitudinal stringers supported by transverse bulkheads and floors

### 2 Deck

Fittings all in stainless steel  
8 x stainless steel deck cleats  
Pulpit and cockpit rails  
Stainless steel fendering with rubber insert  
Curved safety glass windscreen  
Stainless steel bow roller with anchor stop  
Stainless steel bow plate  
Delta anchor and 60m chain (galvanised)  
Electric winch and capstan with deck and cockpit controls  
Chain locker fender stowage  
Fender tie bar under anchor locker lid  
2 x Pantograph windscreen wipers 24v and washers  
Fuel fillers port and starboard  
Fresh-water filler  
IMCO navigation lights  
Ensign staff and socket  
Tender garage

### 3 Bathing platform

Hydraulic lifting platform  
Teak-laid bathing platform and steps  
Hot and cold swimming shower  
Fresh-water marina connection  
Dockside AC shore power connection  
Stainless steel swimming ladder

### 4 Cockpit

Self draining  
Stern safety door  
Radio/CD remote control  
Cockpit speakers  
Wetbar sink with hot and cold water, ice chest, ice maker, bottle locker and griddle  
Deeply upholstered seating around cockpit table  
Lockers beneath seating  
Rear bench seat with convertible sunbather  
Overhead cockpit lights 24v  
Low-level courtesy lights 24v  
Engine room access hatch  
Boat hook

### 5 Helm console

Double stand/sit co-pilot seat and single helm seat  
Chart area  
Console with burr type walnut fascia  
Hydraulic power steering  
Wood rimmed steering wheel  
Full analogue engine instrumentation  
Radar open scanner  
Single lever engine controls  
Autopilot  
Electronic speedlog  
Depth sounder  
Rudder indicator  
Water tank gauge  
Fuel tank gauge  
VHF radio  
Trim tab controls  
Compass  
Horn  
Windscreen wipers and washers  
Glass holders  
Hand-held fire extinguisher  
Radio/CD  
Main control panel (AC/DC)  
Generator controls  
Opening sidewindow

### 6 Deck salon

Large dining/lounging area with dining table  
Scatter cushions  
Lockers beneath seating  
2 x movable comfortable chairs  
Drinks locker  
Air-conditioning  
Flatscreen television with DVD/CD surround system  
Power operated opening sunroof  
Halogen overhead lighting 24v  
Low-level lighting 24v  
Double AC sockets  
Hand-held fire extinguisher  
Teak decking  
Stainless steel triple opening doors to cockpit

### 7 Galley

Sink and drainer  
Electric ceramic hob  
Electric refrigerator  
Electric freezer  
Microwave/grill  
Rubbish bin  
Cupboard and drawer stowage  
8 place crockery set  
8 place cutlery set  
Double AC socket  
Hand-held fire extinguisher  
Opening porthole with mosquito screens and curtains  
First aid kit

1. Upper saloon toward drive station
2. Aft garage
3. The Predator 72
4. Master stateroom
5. Master en suite
6. Aft sun deck
7. Aerial view of the Predator 72
8. Sliding sun roof above drive station



## 8 Breakfast saloon

Breakfast area with dining table  
Lockers beneath seats  
Flatscreen television  
Overhead cupboards  
Opening portholes with mosquito screen and curtains  
Halogen overhead lighting 24v  
Air-conditioning  
Double AC socket  
Vacuum cleaner  
Hand-held fire extinguisher  
Fitted carpet

## 9 Forward stateroom

Double berth  
Storage beneath  
Drawer in base end  
2 x reading lights 24v  
Outboard shelving  
Overhead bedside cupboards  
Hanging wardrobe with mirrored door  
Shelved cupboard  
Halogen overhead lights 24v  
2 x opening portholes with mosquito screens and curtains  
Deck hatch with mosquito screen  
Air-conditioning  
Double AC socket  
Door to shower room  
Fitted carpet  
Flatscreen television  
DVD player

## 10 Forward en suite shower room

Washbasin  
Taps and accessories  
Separate shower compartment  
Vacuum toilet  
Extractor fan  
Mirrored vanity unit  
Shelved cupboard  
Toothbrush glass holder  
Towel ring and towels  
Overhead light  
Opening porthole with mosquito screen and blind  
Shaver socket 240/110v  
Soap dish

## 11 Starboard guest cabin

2 x single berths  
Under berth storage  
2 x reading lights 24v  
Full hanging wardrobe  
Halogen overhead lights 24v  
Opening porthole with mosquito screen and curtain  
Air-conditioning  
Double AC sockets  
Fitted carpet

## 12 Starboard en suite shower room/day head

Washbasin  
Taps and accessories  
Separate shower compartment  
Vacuum toilet  
Extractor fan  
Mirrored vanity unit  
Shelved cupboard  
Toothbrush glass holder  
Towel ring and towels  
Overhead light  
Opening porthole with mosquito screen and blind  
Shaver socket 240/110v  
Soap dish

## 13 Aft master stateroom

Double berth  
Draw stowage  
2 x reading lights 24v  
Outboard shelving  
Bedside drawers  
Walk-in hanging wardrobe  
Halogen overhead lights 24v  
2 x large opening and 4 x fixed portholes with mosquito screen and blinds  
Air-conditioning  
Double AC socket  
Fitted carpet  
Flatscreen television  
DVD player  
Sofa  
Vanity unit with stool

## 14 Master en suite shower room

Washbasin  
Taps and accessories  
Separate shower compartment  
Vacuum toilet  
Extractor fan  
Mirrored vanity unit  
Shelved cupboard  
Toothbrush glass holder  
Towel ring and towels  
Overhead light  
Opening porthole with mosquito screen and blind  
Shaver socket 240/110v  
Soap dish

## 15 Engine compartment and ancillaries

Twin engines  
Soundproofing throughout engine room  
Fuel tanks with electric sending unit  
Separate fuel filters/water separators  
Automatic fire extinguishers  
Engine room and forward bilge flood alarms  
2 x automatic bilge pumps  
2 x automatic flood pumps  
4 x extractor fans 24v  
Manual bilge pump

## 16 Electrical system

Slow speed generator with underwater silent exhaust and sound box  
AC dockside connection  
Galvanic isolator  
24v and 12v DC electrical system with full circuit breaker protection  
6 x engine batteries 24v circuit  
4 x domestic batteries 24v circuit  
2 x generator batteries 12v circuit  
Alternator split charging system  
Remote battery switches controlled from locker in cockpit  
Battery charger for 24v circuits  
Battery charger for 12v circuits  
Water heater  
AC sockets throughout the boat  
24v hand light and cable

## 17 Underwater gear

5-blade NAB bronze propellers  
Bronze P-brackets  
2 x 2 1/4" stainless steel Temet 25 shafts  
Dripless shaft logs with spare seals  
High-performance bronze rudders and struts  
Seawater strainers – 2 x main engines/1 x generators  
Seacocks on all underwater fittings  
Full cathodic bonding system to zinc anodes  
Heavy duty S/S hydraulic trim tabs 24v

## 18 Systems

Hydraulic power steering engine driven pump  
Vacuum toilet system  
Aluminium fresh-water tank with electric sending unit  
24v fresh-water pressure system  
Hot water tank

## 19 Miscellaneous

Toolkit  
Boat hook  
Mooring ropes x 4  
Fenders x 6  
Spare bulbs and fuses  
2 sets towels

## 20 Optional extras

Retractable bimini top  
Twin berth crew cabin aft with separate toilet  
Pullman cabin to replace the lower breakfast saloon  
Teak side decks

## US specification includes:

US Coast Guard build regulations  
US specification appliances



\*Every attempt has been made to give accurate information, but performance and range figures are estimates given as a guide only. Dirt or growth on the hull, tuning of the engines, size, make of engines fitted, damage to propellers, the temperature of the air and water, the weight of fuel, water, stores, number of people, propeller pitch, quality of fuel and other matters, can all affect a boat's performance and range. For these and other reasons we can give no performance, range or other guarantees, and neither such guarantees nor anything contained herein constitutes an offer of contract or any representation or agreement, or may otherwise be relied upon. The photographs and artist's impressions in this brochure are of existing models in the Sunseeker range. There may be items shown in these photographs and artist's impressions that are not included in the standard inventory of the models shown. Specifications contained on the web site are samples only and should not be relied upon and may refer to models only intended for sale in a particular territory and not generally. No guarantee is given that any model will be available in any territory; however by contacting us we can advise you of models that are likely to be available in each territory. Actual specifications will be provided when a sales order or enquiry is placed with us or our approved Sunseeker dealer.

Specifications for models sold in different markets may vary and specifications and models may be changed or withdrawn at any time without prior notice. The individual specification for each vessel will be agreed as part of the sale contract between the purchaser and the Sunseeker dealer. Dealers and distributors are independently owned and operated entities, and therefore Sunseeker dealers and distributors are not owned by Sunseeker International Limited or any subsidiaries or other related entity of this company nor are they their agents. Therefore they have absolutely no authority to commit Sunseeker International Limited, or any subsidiary or other related entities of Sunseeker International Limited to any pledge, contract or agreement in any form or by any means unless first accepted in writing by Sunseeker International Limited. In some examples herein Sunseeker have referred to measurements, specifications or other details applicable to a particular territory and no guarantee is given that these are applicable to your territory. For ease of reference we have, in some cases, referred to "we" or "Sunseeker" and these terms should be taken to mean Sunseeker International Limited.



## Awards

Sunseeker's success over the years is clearly underlined by the following list of national and international awards and achievements.

2008	UK Motor Boat of the Year Awards 2008	Manhattan 60	2001	Best Power Interior Award	105 Yacht, The Superyacht Society
2007	European Powerboat of the Year	Superhawk 43	2001	President's Award	Southern California Marine Association
2007	Asia Pacific Boating Awards	90 Yacht, Best of the Best	2000	Queen's Award for Enterprise	Continuous innovation and development
2007	Modern Boating Magazine 2007	Portofino 47, Imported Powerboat of the Year	2000	The Times Exporter of the Year	Times Export Awards
2007	Australian Marine Industries Federation Awards	Predator 62, Imported Powerboat of the Year	2000	Robb Report Award	Best of the Best, Boating and Sailing
2007	Nominated by The Superyacht Society	37 Metre Yacht 'The Snapper'	1999	Robb Report Award	Best of the Best, Boating and Sailing
2007	Queen's Award for Enterprise	International Trade	1999	Motorboat of the Year	Predator 75, BT British Nautical Awards
2006	Nominated for three Superyacht Awards	Predator 108 'SHIVER'	1998	Superyacht Design Award	Manhattan 74, Superyacht Design Awards
2005	Australian Marine Industries Federation Awards	75 Yacht, Non-Trailable Boat Award	1998	Editor in Chief Awards	Yachts Magazine
2005	Australian Marine Industries Federation Awards	Portofino 46, Commendation	1997	Lifetime Achievement Award	Robert Braithwaite MBE, RYA Awards
2005	Modern Boating, Power Boat of the Year Awards	Predator 68, Imported Powerboat of the Year	1996	Motorcruiser of the Year Award	RYA British Nautical Awards
2005	Boats.com Marine Industry Web Awards	Manufacturers Category for www.sunseeker.com	1996	Exporter of the Year Award	DCCI Export Awards
2004	Sydney Boat Show 2004	Best Overall Display	1995	Boat Builder of the Year Award	RYA/BMIF British Nautical Awards
2004	Sydney Boat Show 2004	Best Marina Display	1994	Queen's Award for Export Achievement	Queen's Awards for Industry
2003	Australian Marine Awards	Manhattan 56, Award for Excellence	1992	Best in the World Award	Renegade 60, Boating Magazine
2003	Australian Marine Awards	Predator 68, Best Imported Non-Trailable Yacht	1990	Exporter of the Year	SW International Business Awards
2002	Entrepreneur of the Year Award	Robert Braithwaite MBE	1989	Queen's Award for Export Achievement	Queen's Awards for Industry
2001	Best Power Design Award	105 Yacht, The Superyacht Society	1987	Queen's Award for Export Achievement	Queen's Awards for Industry

### Naval architects

Don Shead/Sunseeker Design

### Exterior styling

Sunseeker Design

### Interior design

Sunseeker Design

### Builder

Sunseeker International

\*Every attempt has been made to give accurate information, but performance and range figures are estimates given as a guide only. Dirt or growth on the hull, tuning of the engines, size, make of engines fitted, damage to propellers, the temperature of the air and water, the weight of fuel, water, stores, number of people, propeller pitch, quality of fuel and other matters, can all affect a boat's performance and range. For these and other reasons we can give no performance, range or other guarantees, and neither such guarantees nor anything contained herein constitutes an offer of contract or any representation or agreement, or may otherwise be relied upon. The photographs and artist's impressions in this brochure are of existing models in the Sunseeker range. There may be items shown in these photographs and artist's impressions that are not included in the standard inventory of the models shown. Specifications contained on the web site are samples only and should not be relied upon and may refer to models only intended for sale in a particular territory and not generally. No guarantee is given that any model will be available in any territory; however by contacting us we can advise you of models that are likely to be available in each territory. Actual specifications will be provided when a sales order or enquiry is placed with us or our approved Sunseeker dealer. Specifications for models sold in different markets may vary and specifications and models may be changed or withdrawn at any time without prior notice. The individual specification for each vessel will be agreed as part of the sale contract between the purchaser and the Sunseeker dealer. Dealers and distributors are independently owned and operated entities, and therefore Sunseeker dealers and distributors are not owned by Sunseeker International Limited or any subsidiaries or other related entity of this company nor are they their agents. Therefore they have absolutely no authority to commit Sunseeker International Limited, or any subsidiary or other related entities of Sunseeker International Limited to any pledge, contract or agreement in any form or by any means unless first accepted in writing by Sunseeker International Limited. In some examples herein Sunseeker have referred to measurements, specifications or other details applicable to a particular territory and no guarantee is given that these are applicable to your territory. For ease of reference we have, in some cases, referred to "we" or "Sunseeker" and these terms should be taken to mean Sunseeker International Limited.

Designed, written and produced by Marketing Matters Limited. Printed in England. August 2008. ©Sunseeker International.



Sunseeker International Limited has CE Approval which is compulsory for all boats with a LOA of 24m and below when sold in the EU.